

FIRST AID KIT and AED LOCATIONS

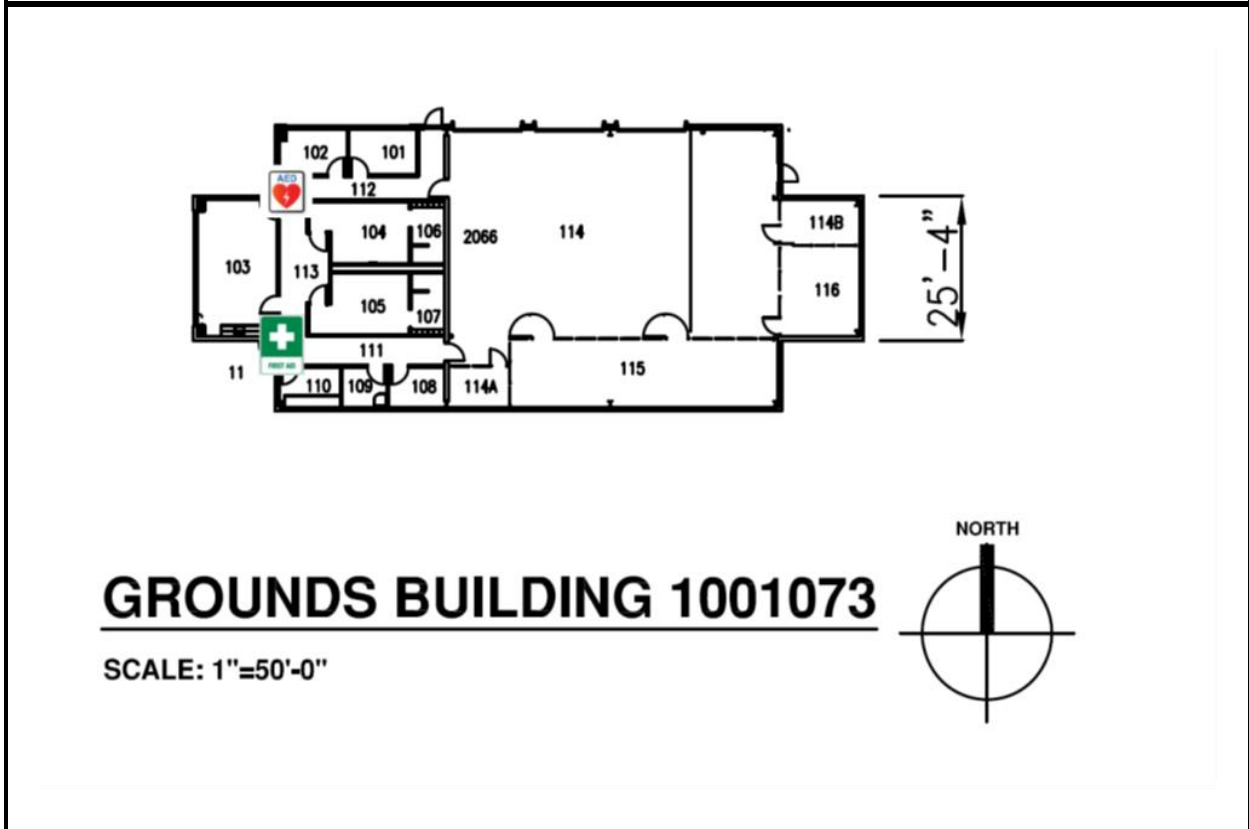

Revision Date: 09/01/2022	Author: D. Fogle
Effective Date: 01/04/2022	Approver: EHS Director

FIRST AID KIT and AED LOCATIONS

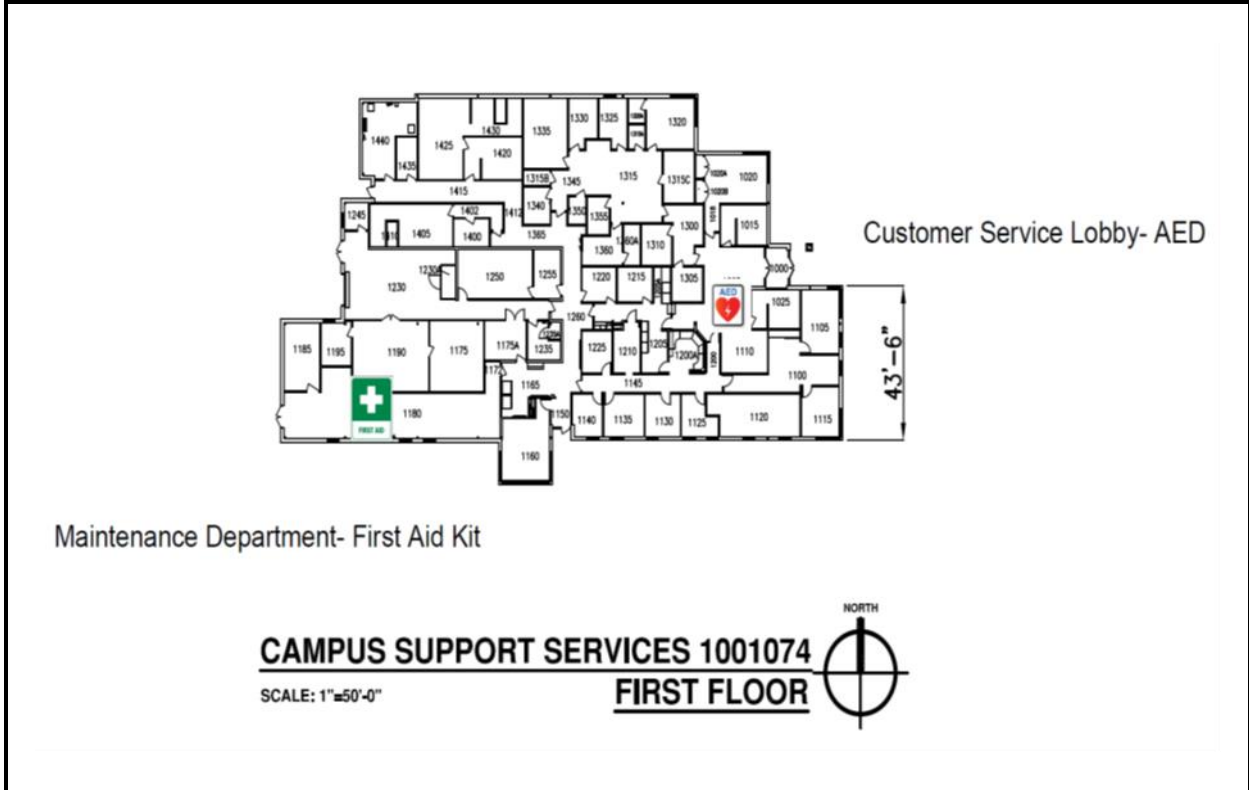
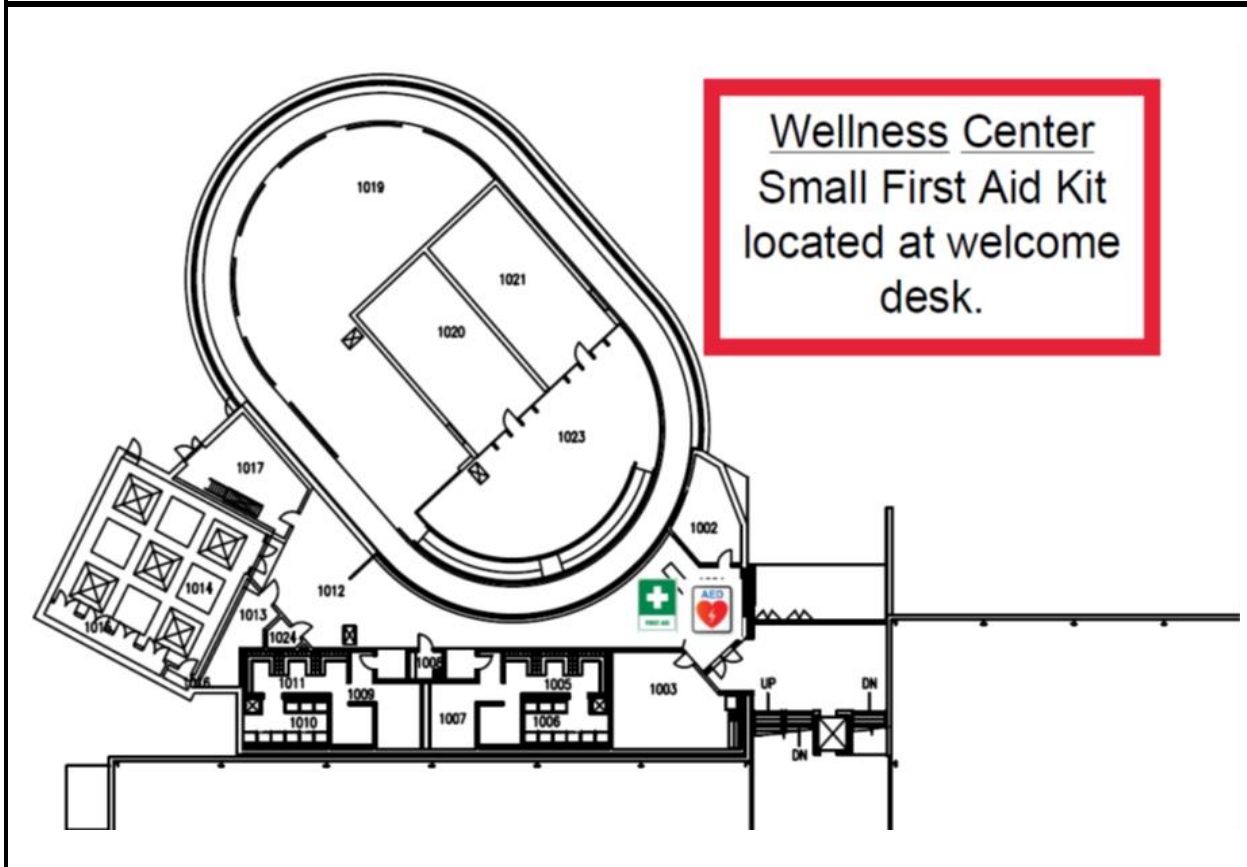
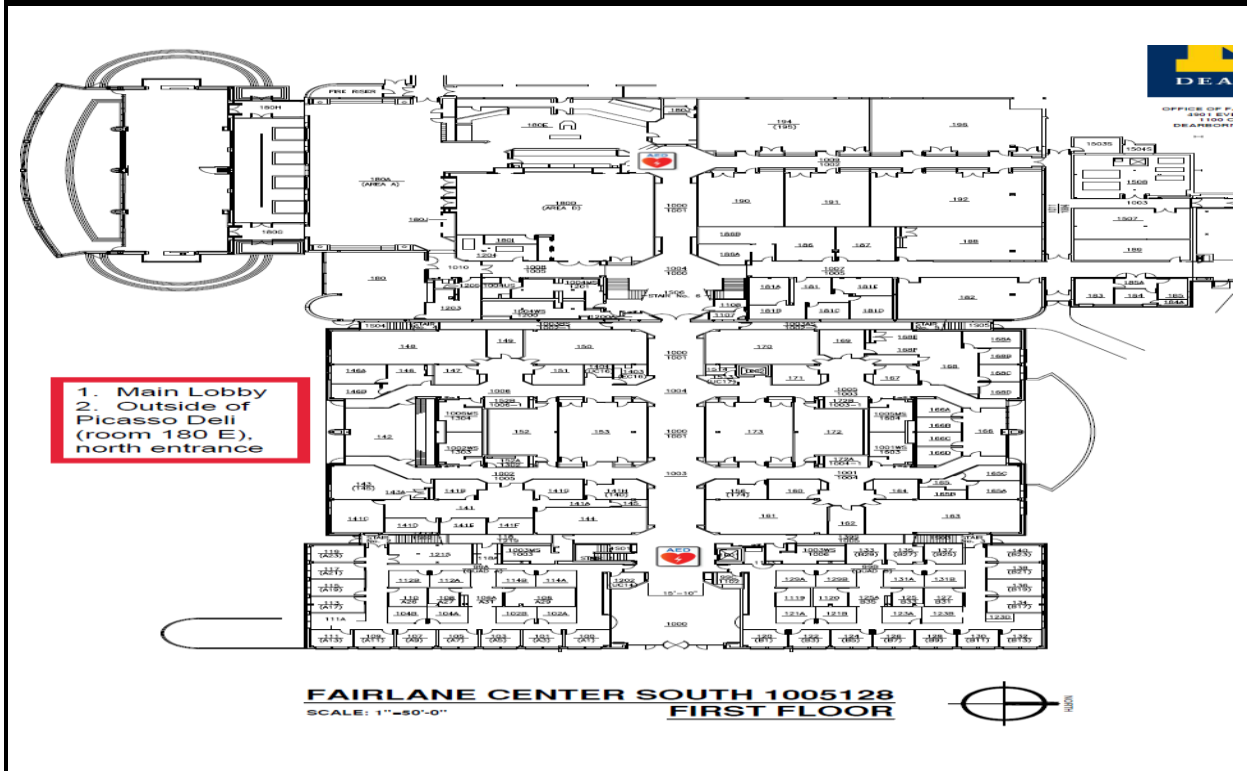

Revision Date: 09/01/2022	Author: D. Fogle
Effective Date: 01/04/2022	Approver: EHS Director

FIRST AID KIT and AED LOCATIONS

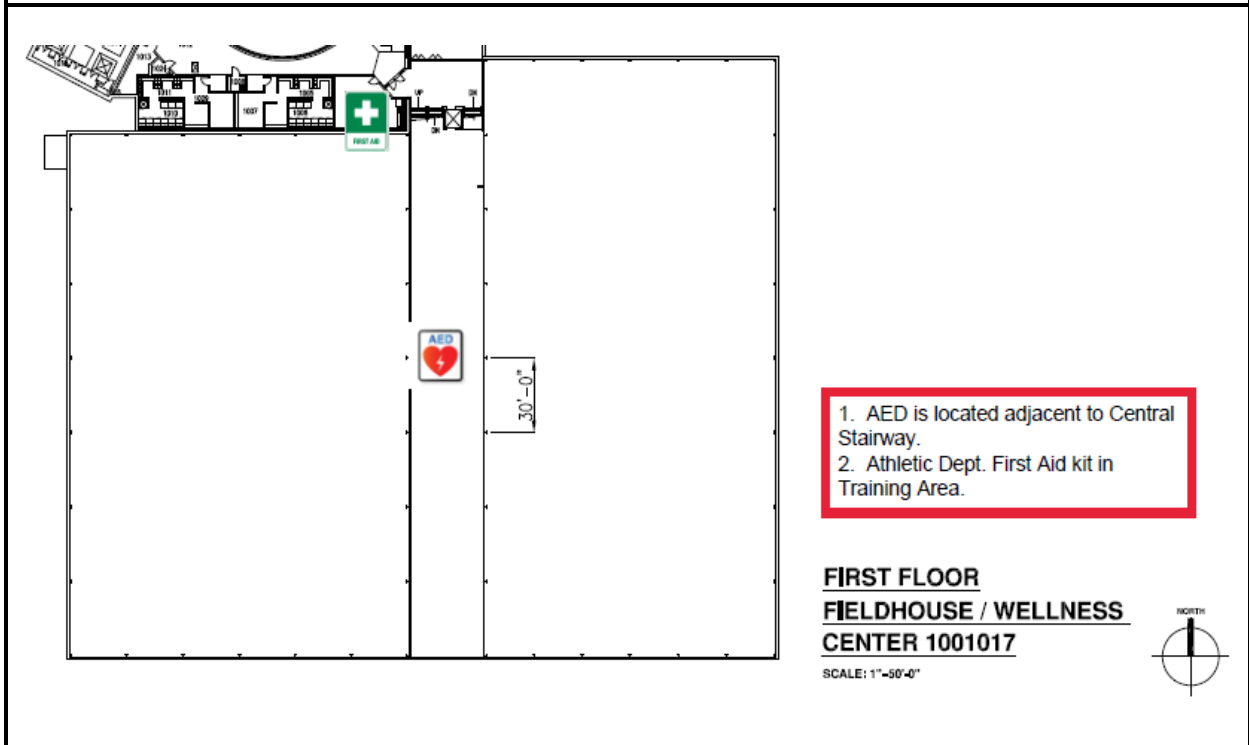
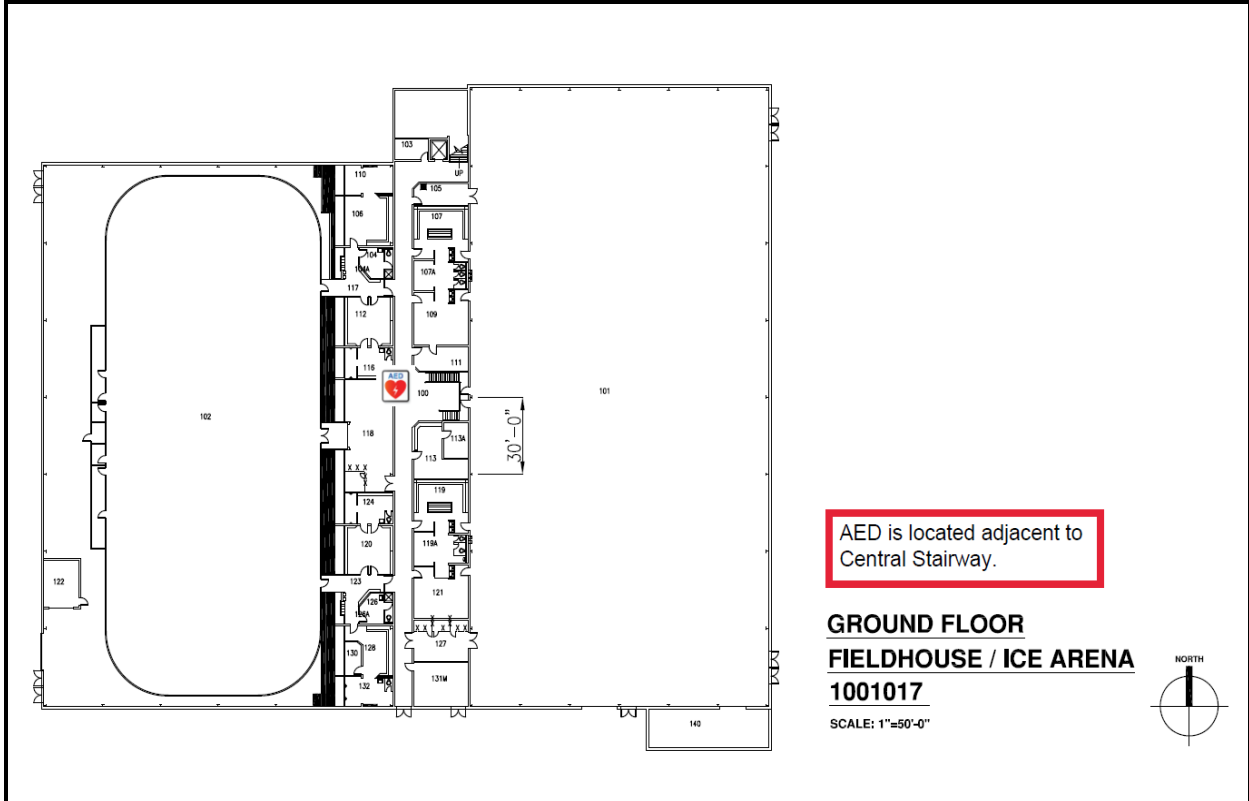

Revision Date: 09/01/2022	Author: D. Fogle
Effective Date: 01/04/2022	Approver: EHS Director

FIRST AID KIT and AED LOCATIONS

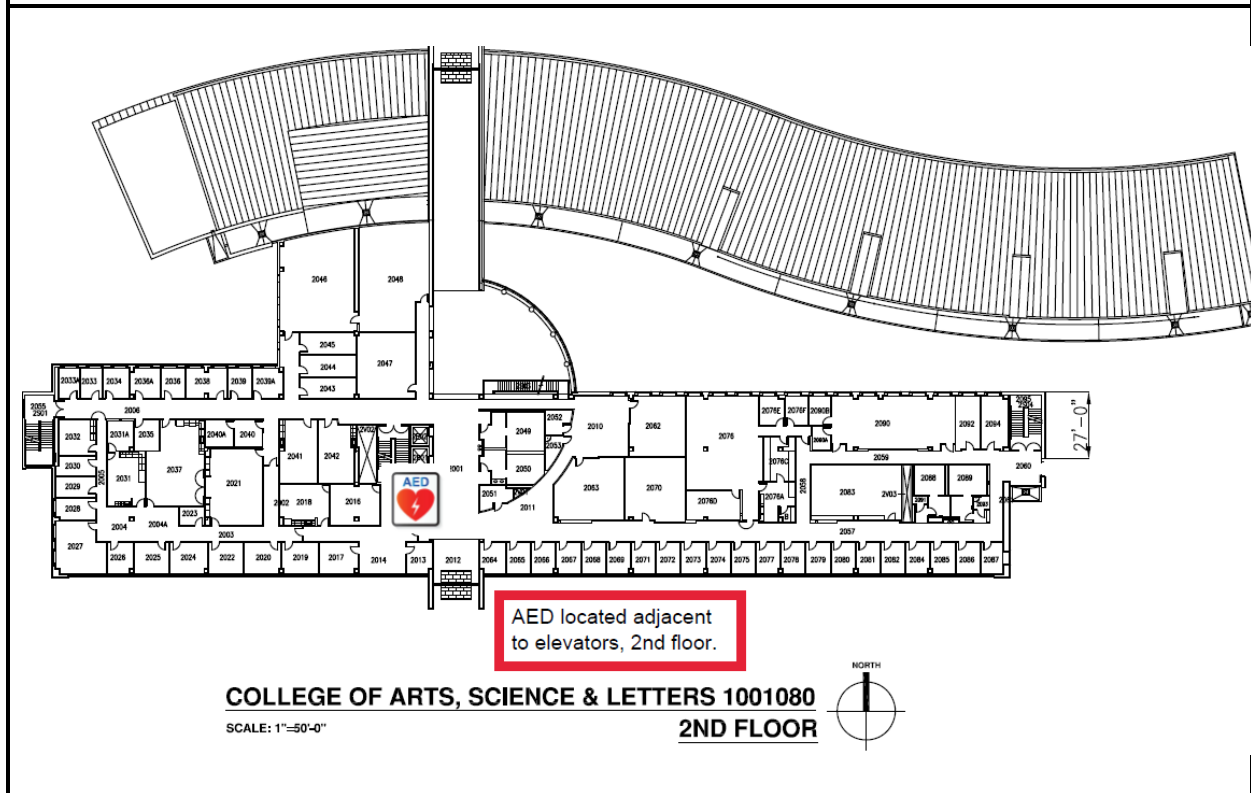
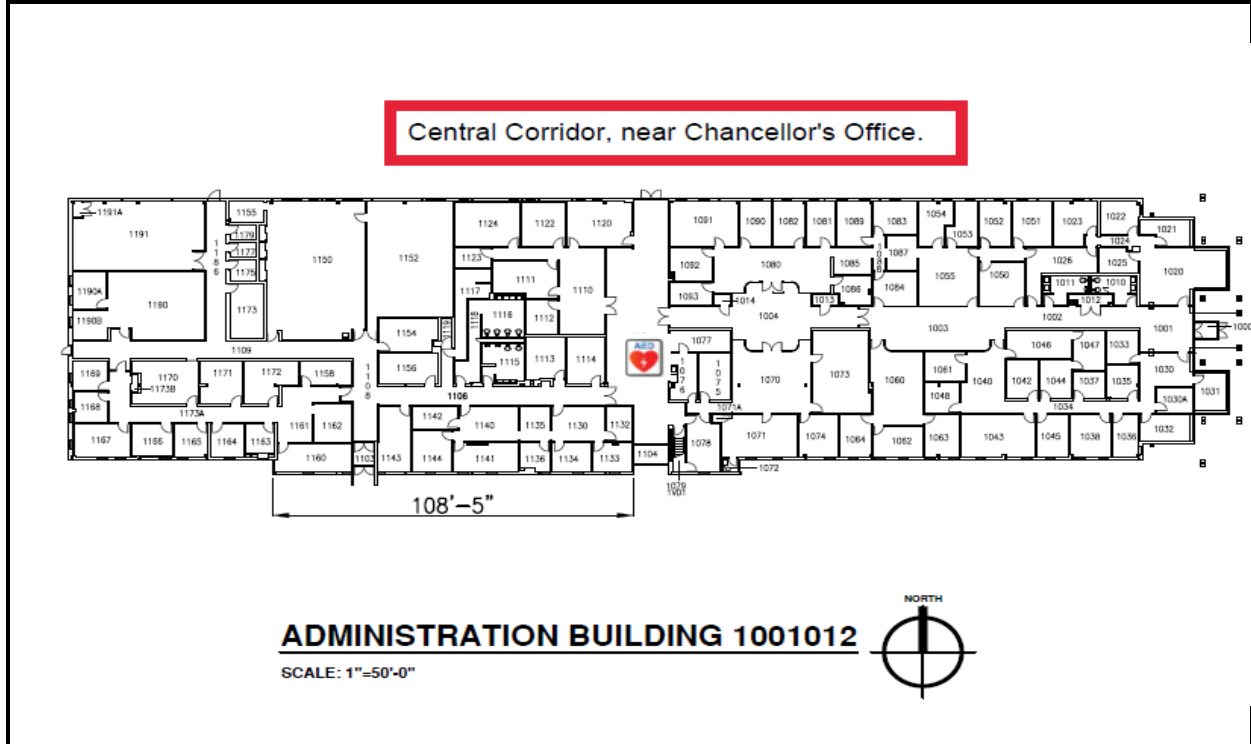

Revision Date: 09/01/2022	Author: D. Fogle
Effective Date: 01/04/2022	Approver: EHS Director

FIRST AID KIT and AED LOCATIONS

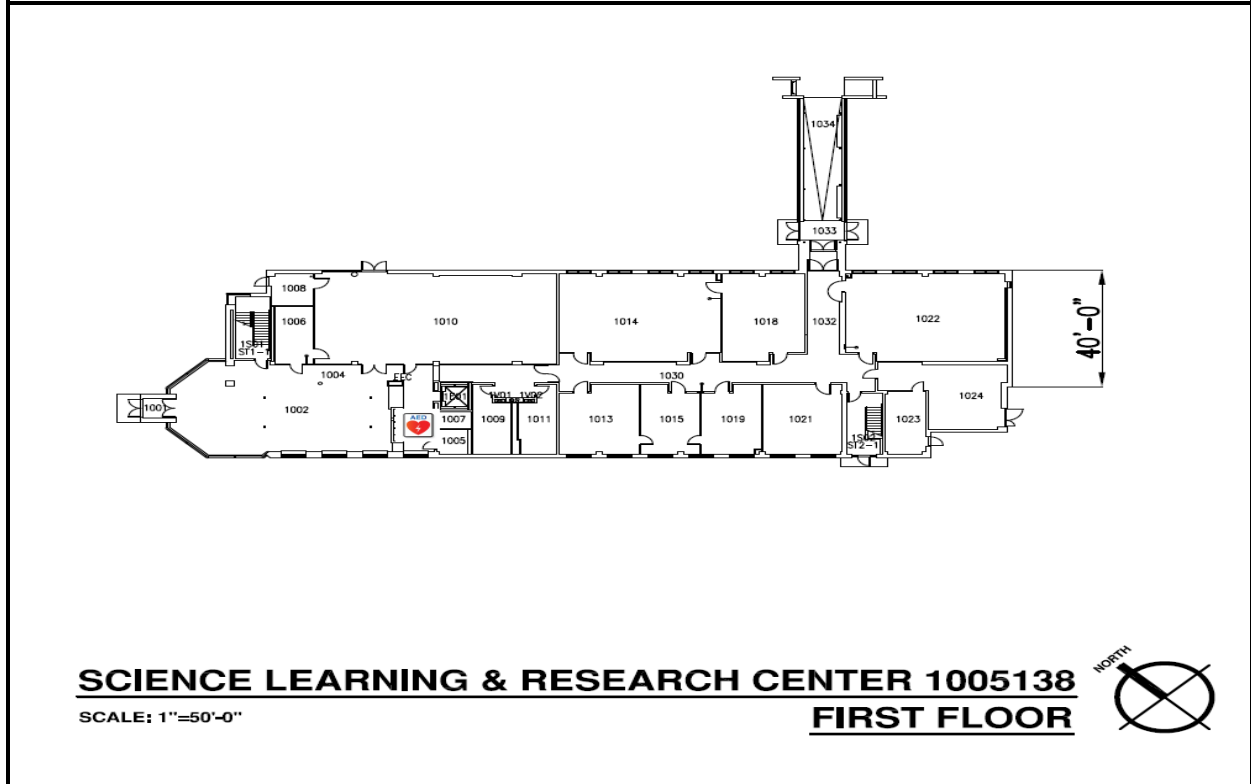
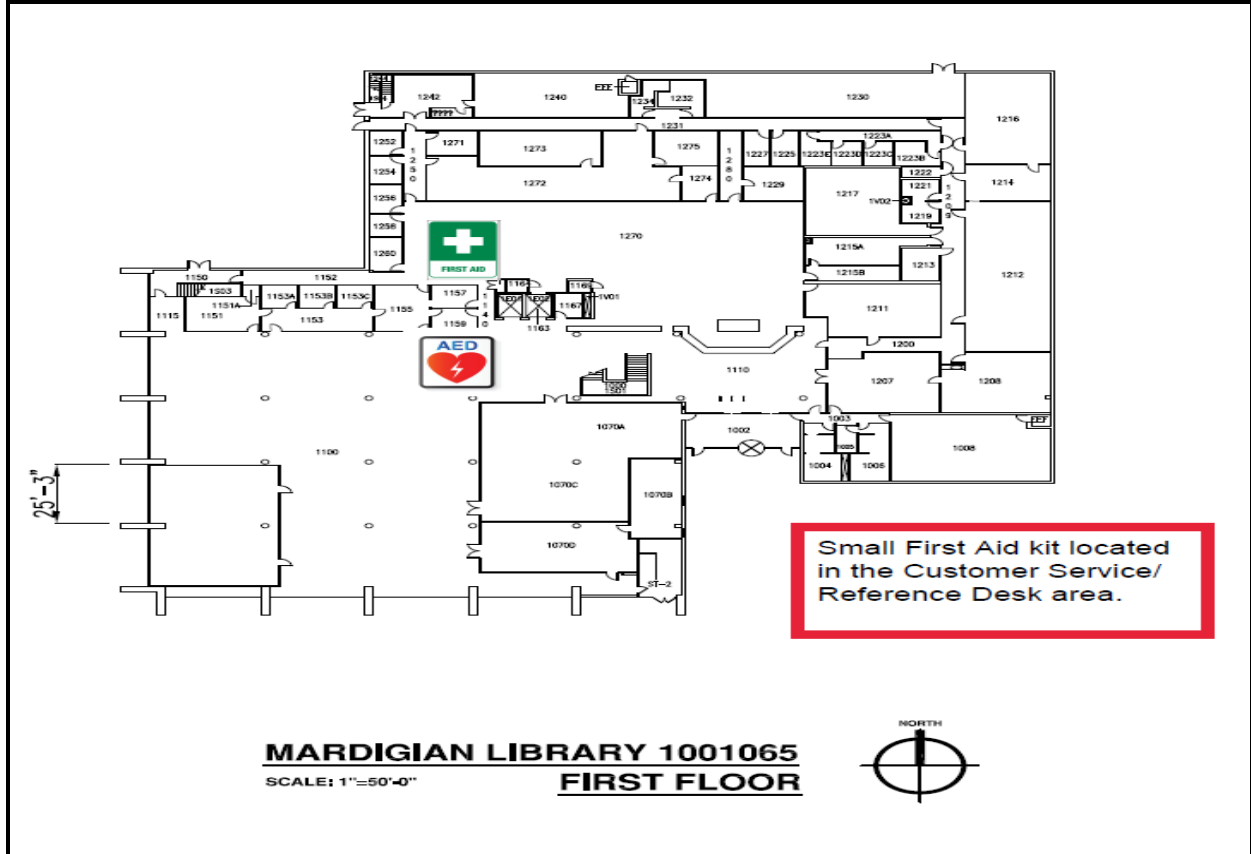

Revision Date: 09/01/2022	Author: D. Fogle
Effective Date: 01/04/2022	Approver: EHS Director

FIRST AID KIT and AED LOCATIONS

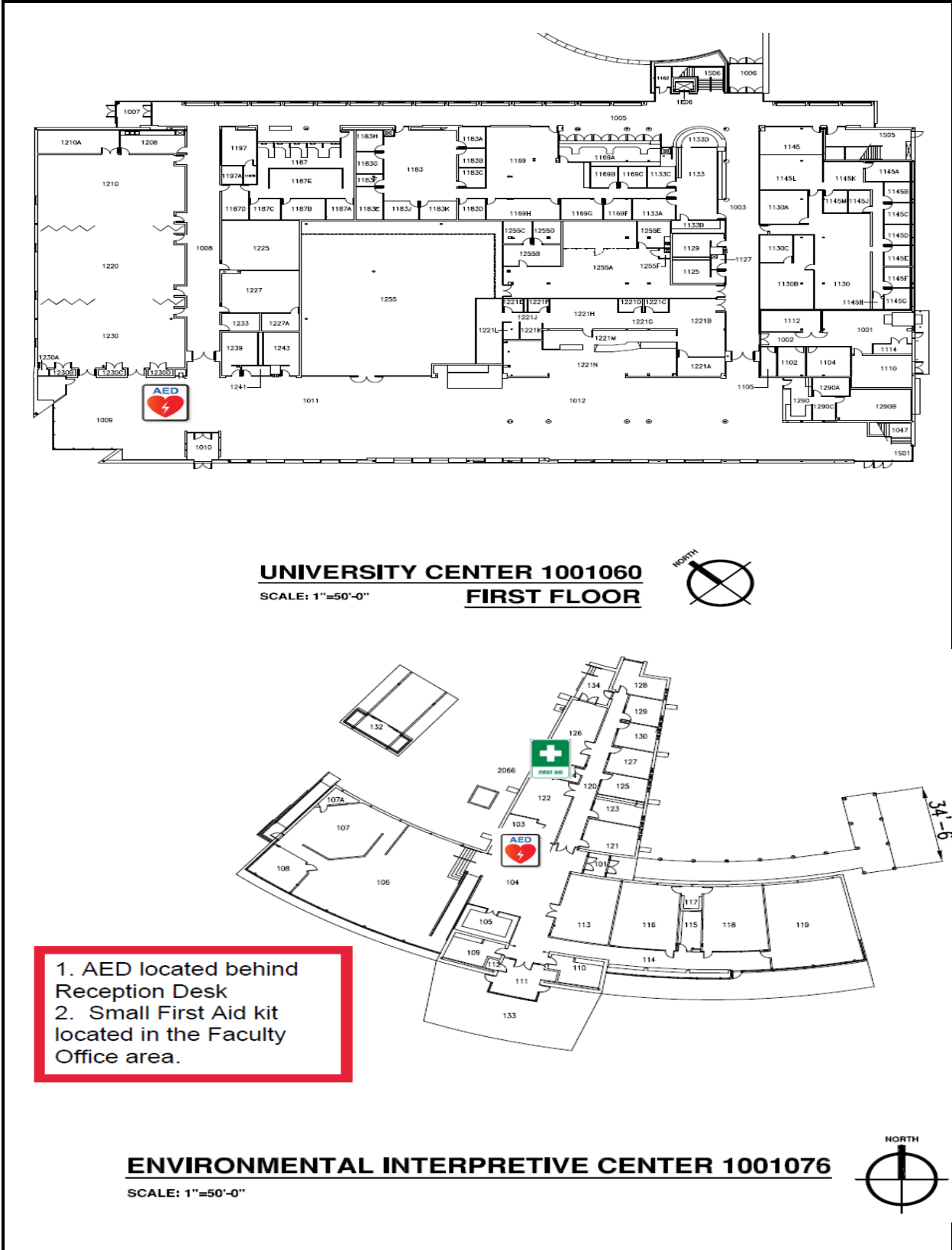

Revision Date: 09/01/2022	Author: D. Fogle
Effective Date: 01/04/2022	Approver: EHS Director

FIRST AID KIT and AED LOCATIONS

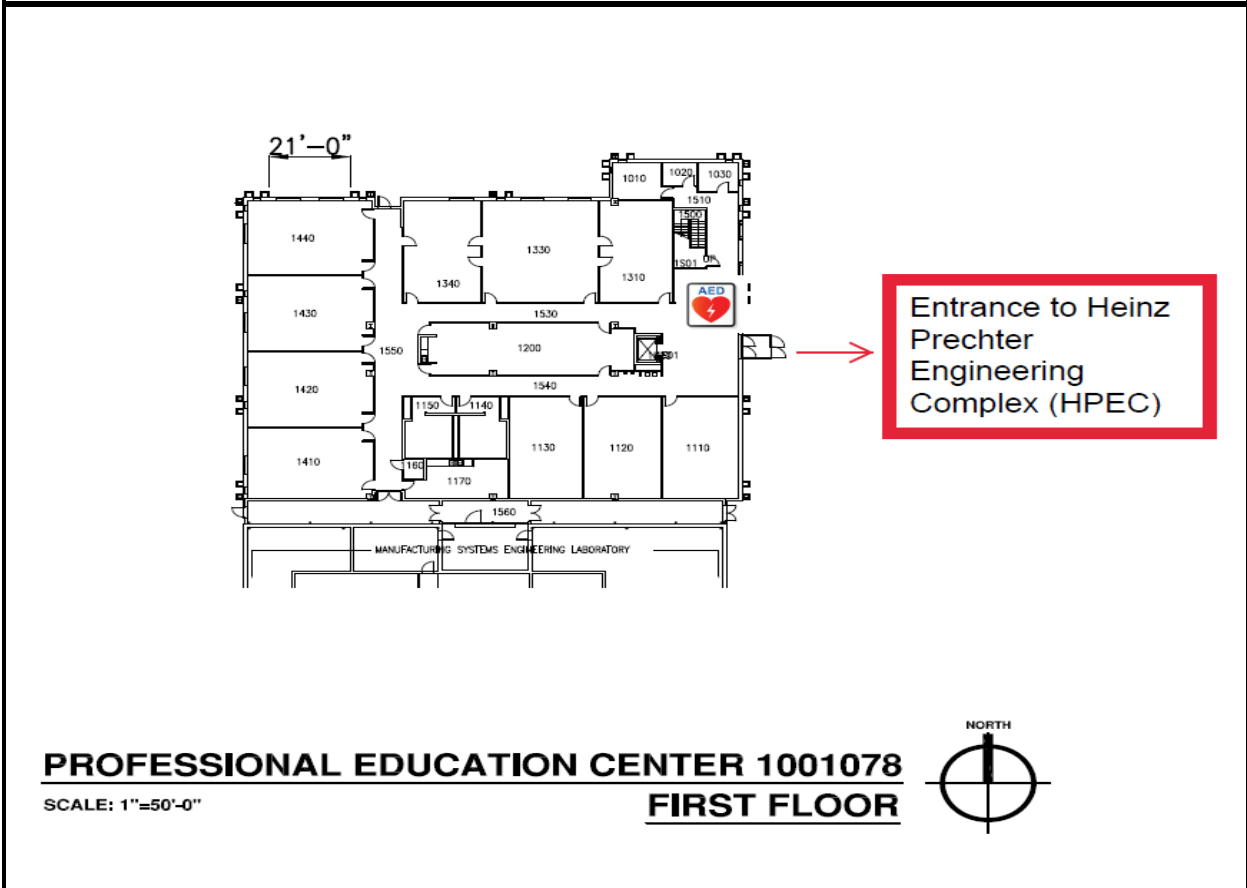
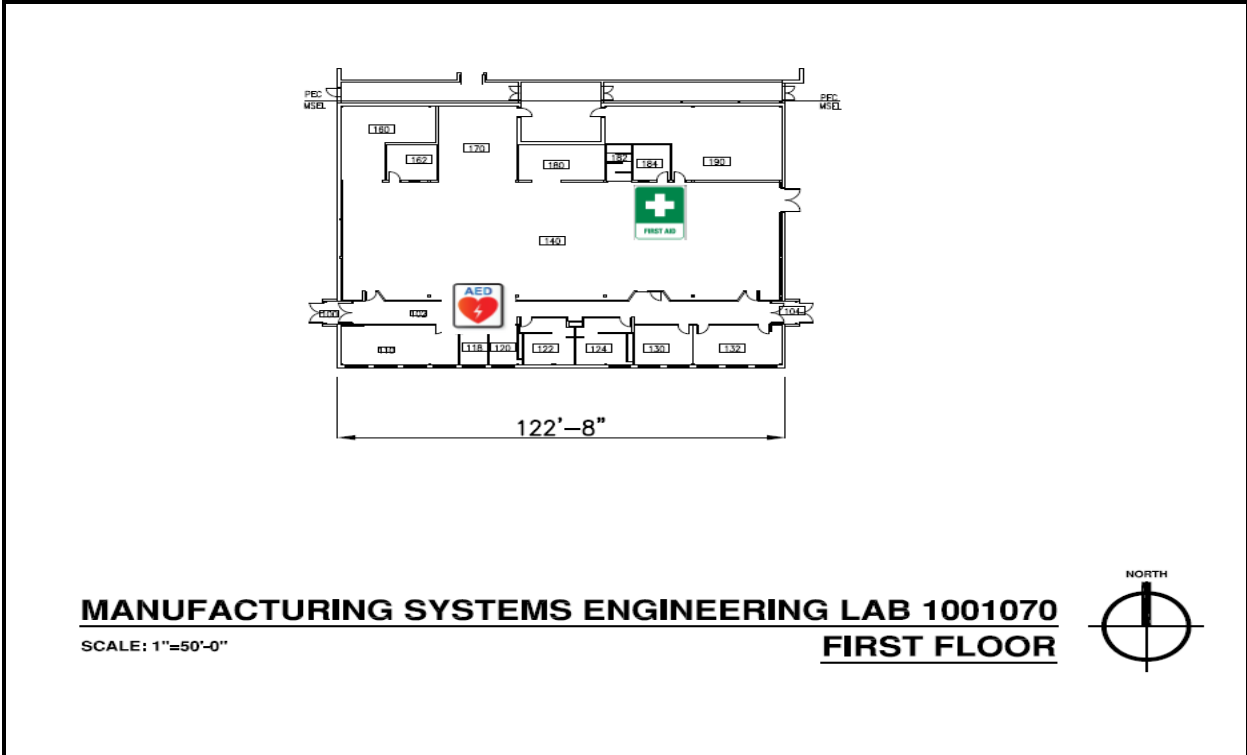

Revision Date: 09/01/2022	Author: D. Fogle
Effective Date: 01/04/2022	Approver: EHS Director

FIRST AID KIT and AED LOCATIONS

**AED located in Room 133
 (Break Room/Kitchenette)**

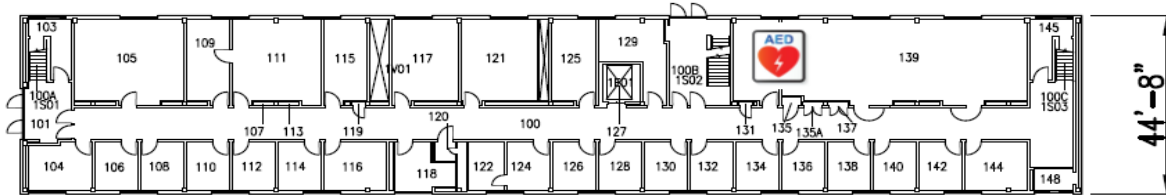

COMPUTER INFORMATION SCIENCE 1001011
 SCALE: 1"=50'-0" **1ST FLOOR**

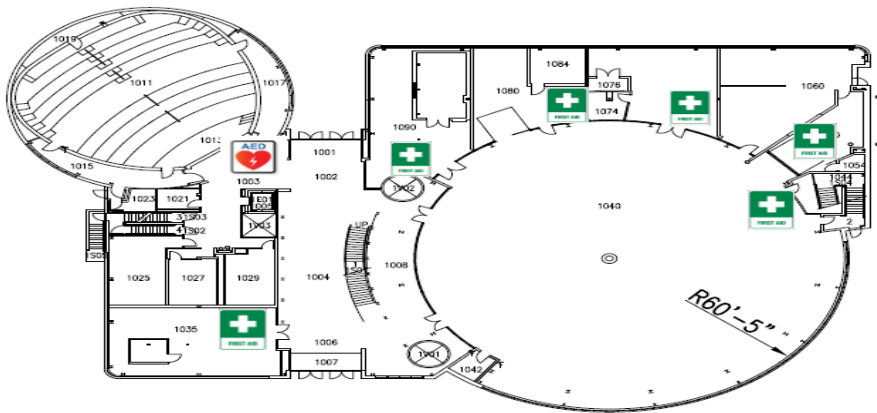

- 1. Small First Aid kits are located in the following Rooms: 1035, 1040, 1070, 1080, 1090.
- 2. First Aid cabinet located in Room 1050.

INSTITUTE OF ADVANCED VEHICLE SYSTEMS 1005137
 SCALE: 1"=50'-0" **FIRST FLOOR**



Revision Date: 09/01/2022	Author: D. Fogle
Effective Date: 01/04/2022	Approver: EHS Director

FIRST AID KIT and AED LOCATIONS

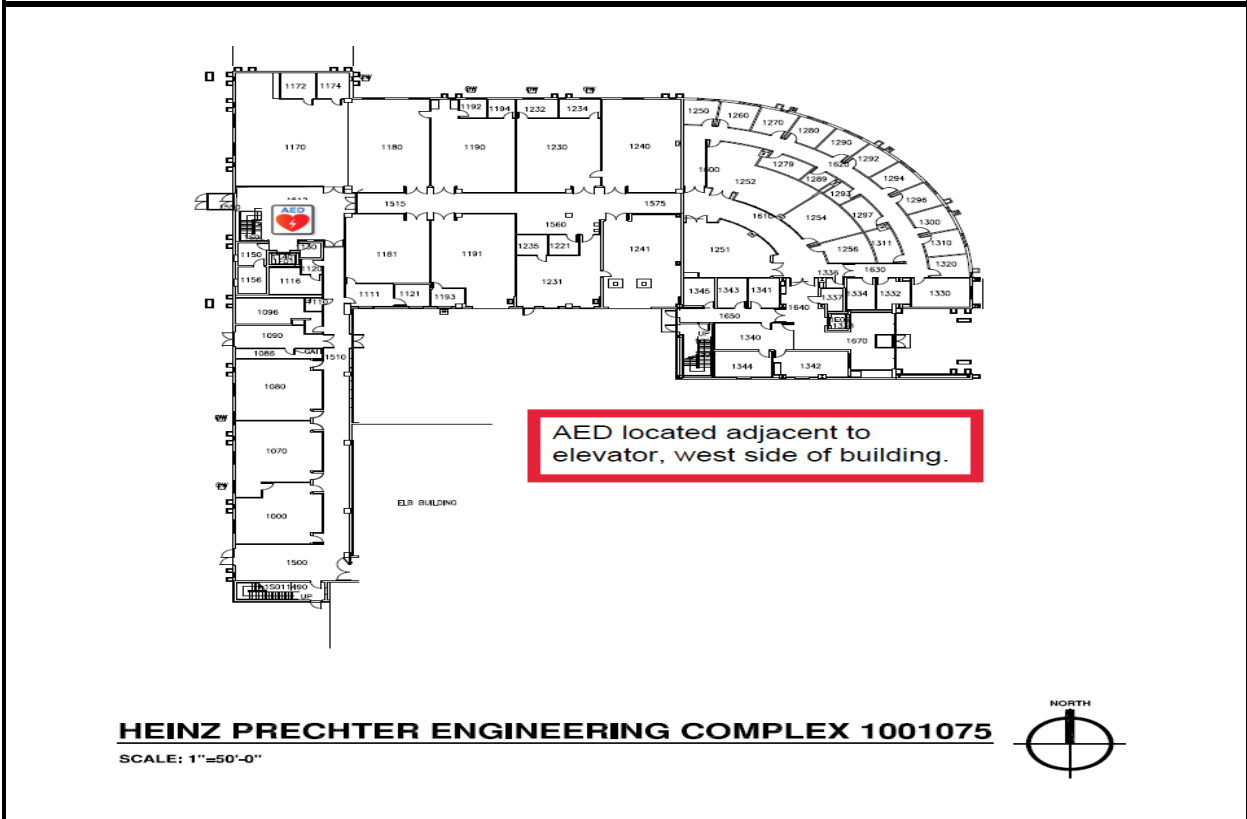
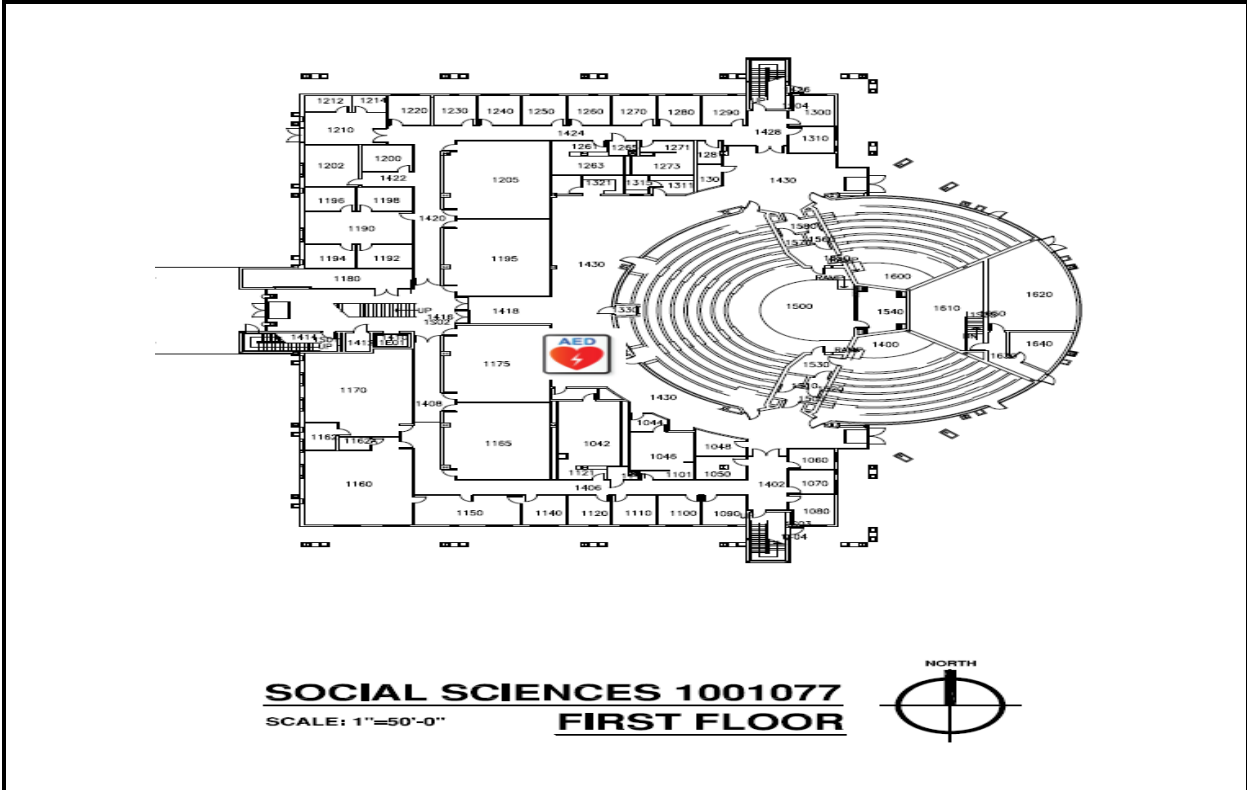

Revision Date: 09/01/2022	Author: D. Fogle
Effective Date: 01/04/2022	Approver: EHS Director

FIRST AID KIT and AED LOCATIONS

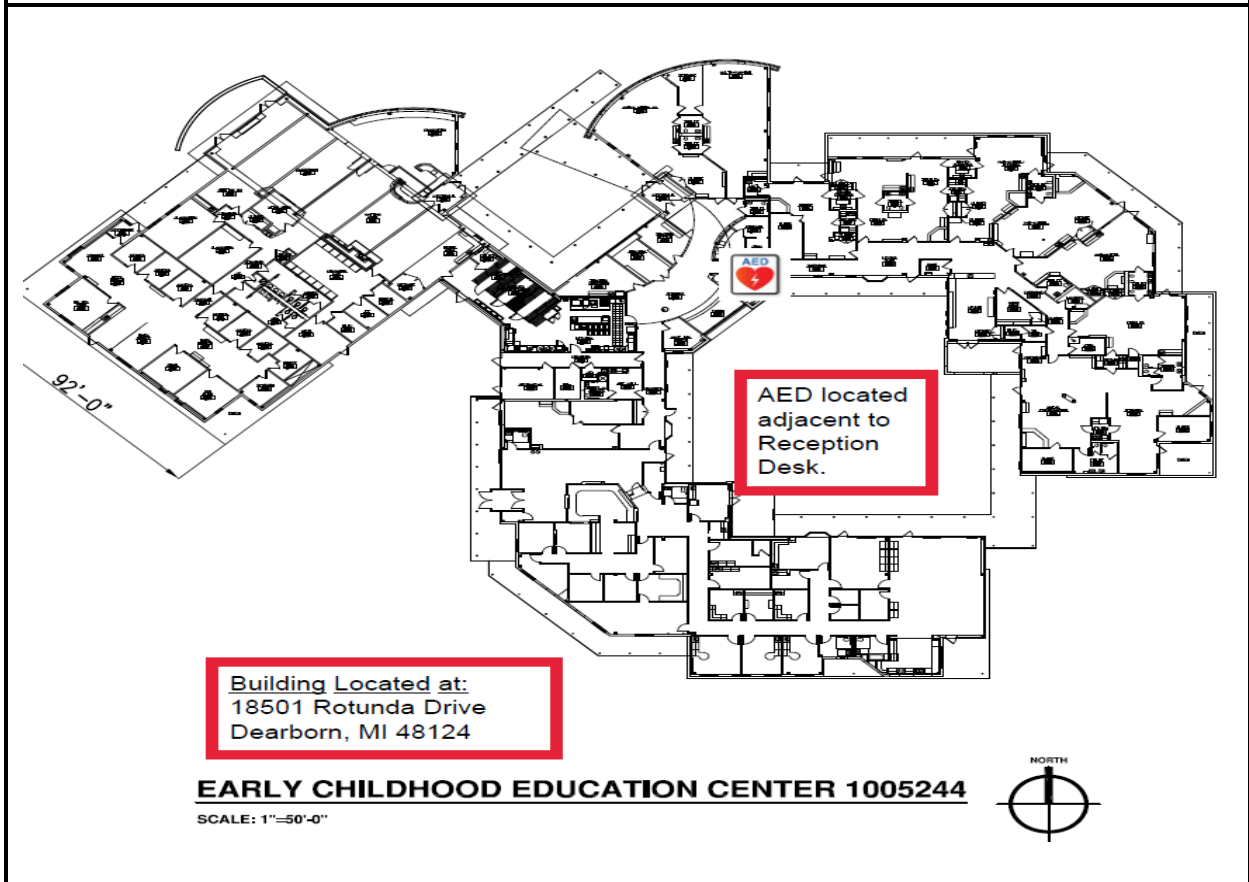
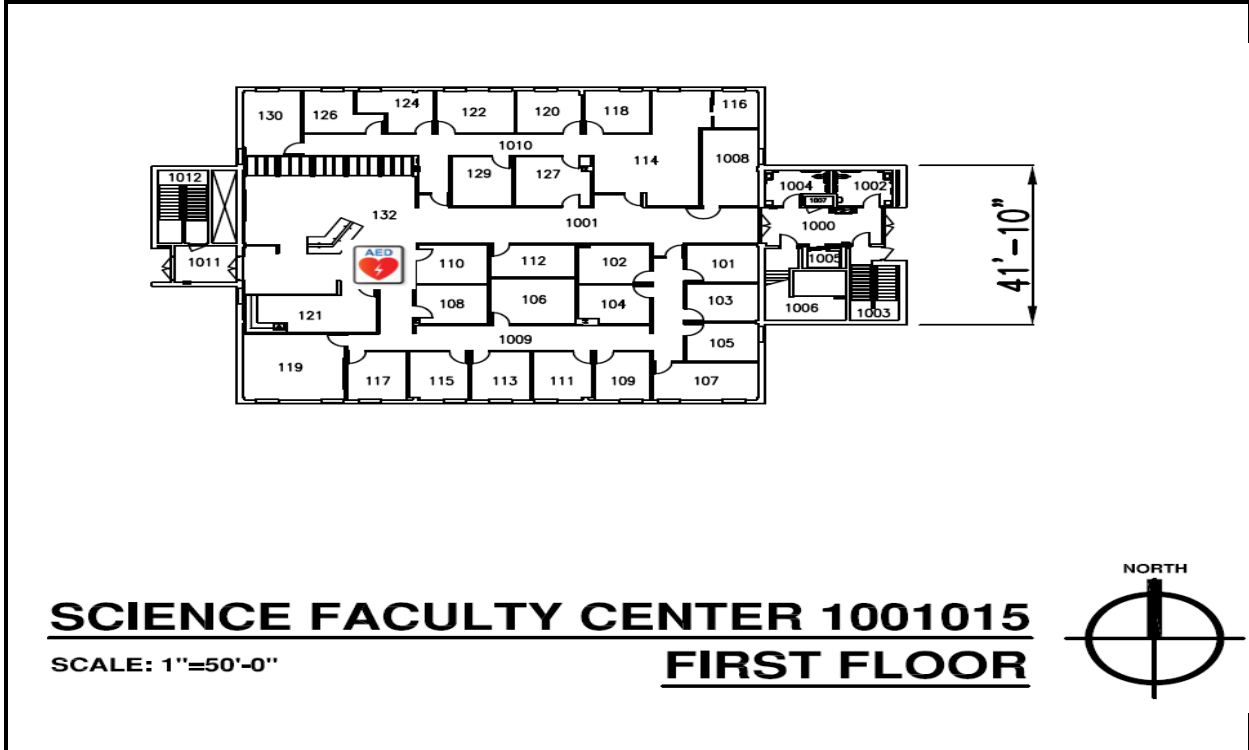

Revision Date: 09/01/2022	Author: D. Fogle
Effective Date: 01/04/2022	Approver: EHS Director

FIRST AID KIT and AED LOCATIONS

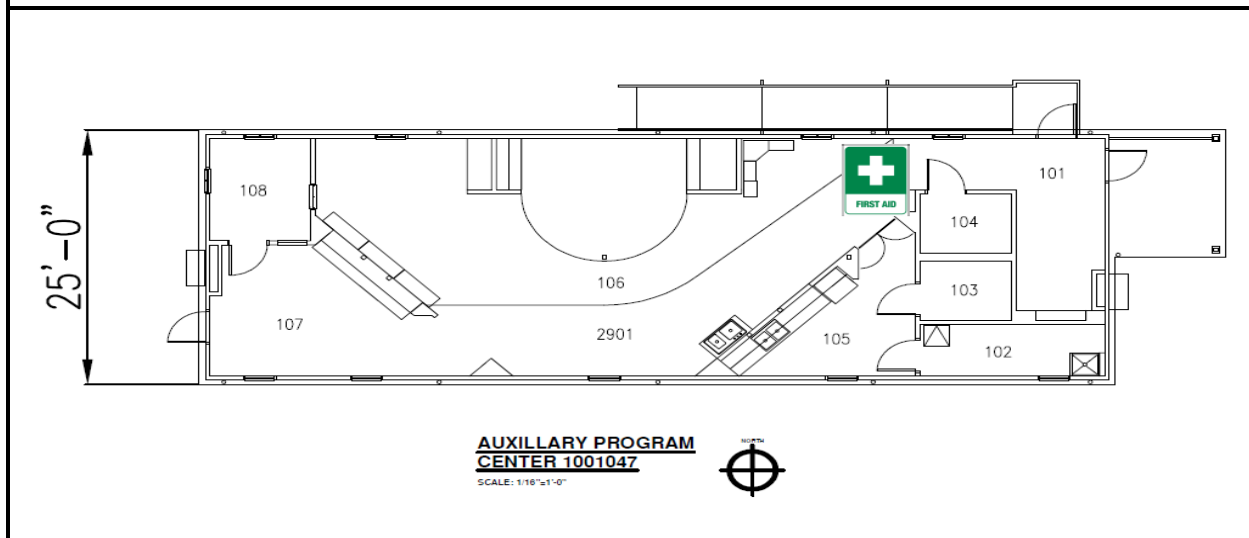
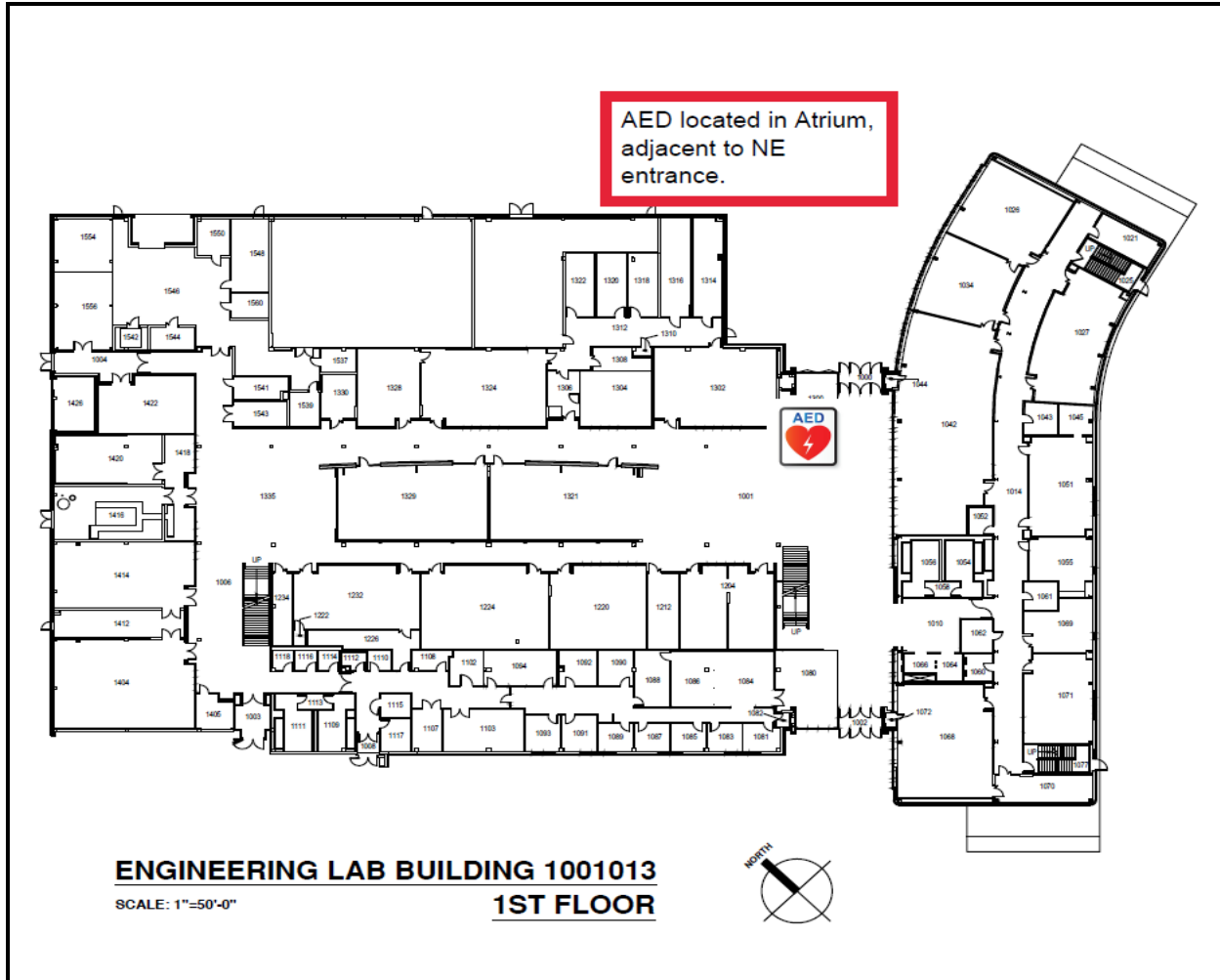

Revision Date: 09/01/2022	Author: D. Fogle
Effective Date: 01/04/2022	Approver: EHS Director

FIRST AID KIT and AED LOCATIONS

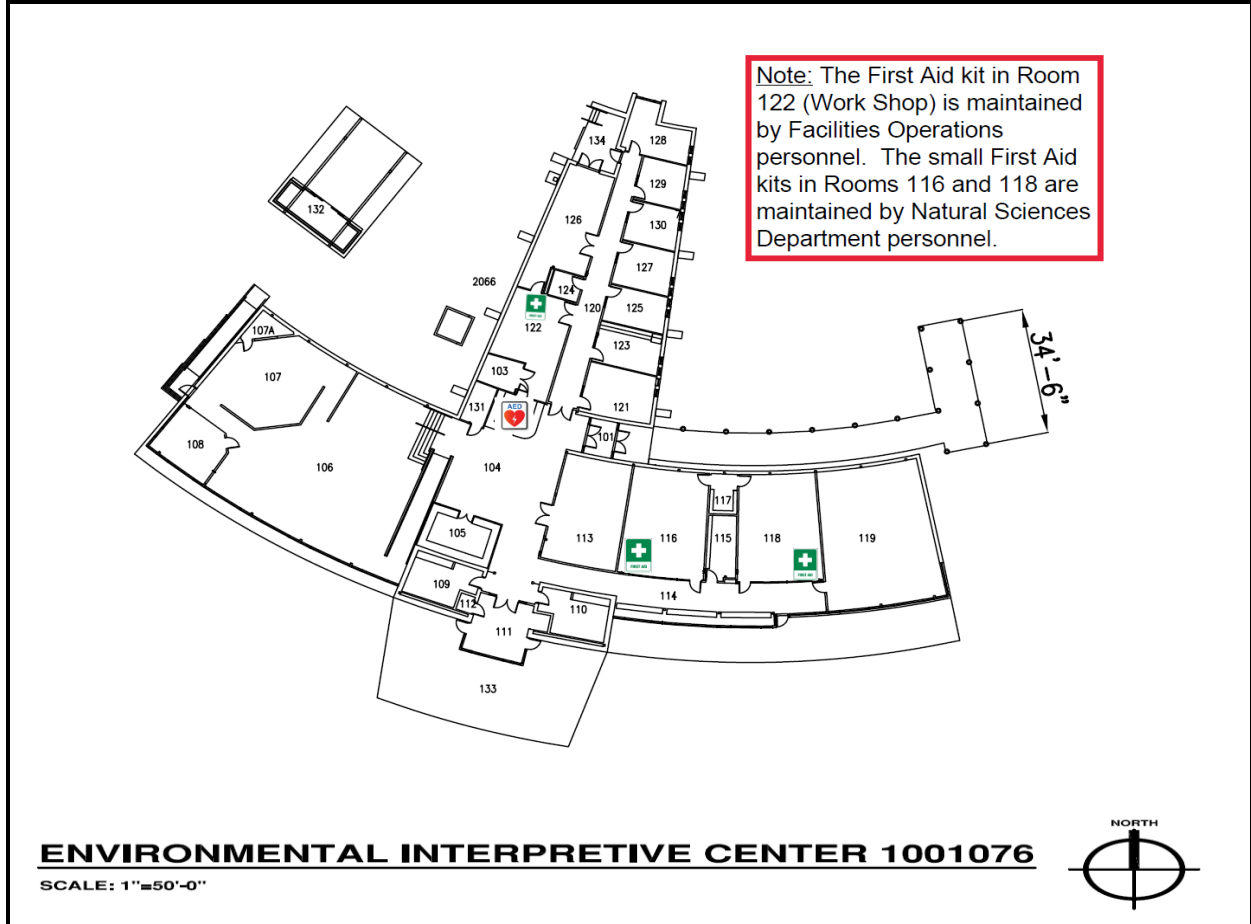

AEDs and First Aid kits are in the following vehicles:

Patrol Vehicle #1
 Patrol Vehicle #2



Revision Date: 09/01/2022	Author: D. Fogle
Effective Date: 01/04/2022	Approver: EHS Director